

**BÂTIMENT PRINCIPAL : 1<sup>ER</sup> ETAGE**

**DORTOIR GYPAETE : 17 PLACES**

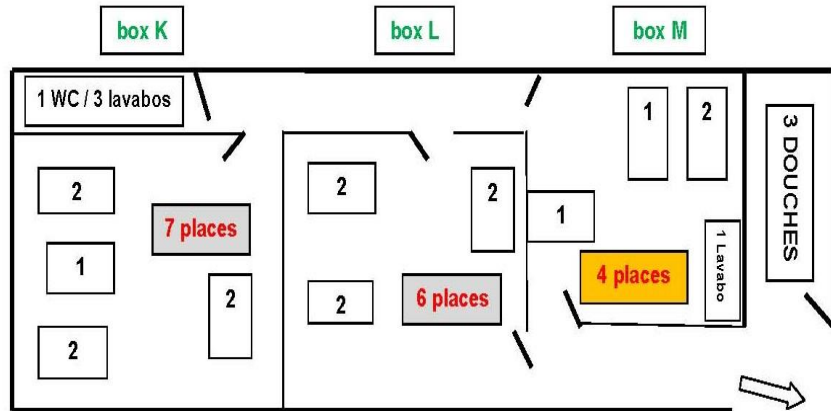

**BÂTIMENT PRINCIPAL 1<sup>ER</sup> ETAGE**

**DORTOIR OURS : 37 PLACES**

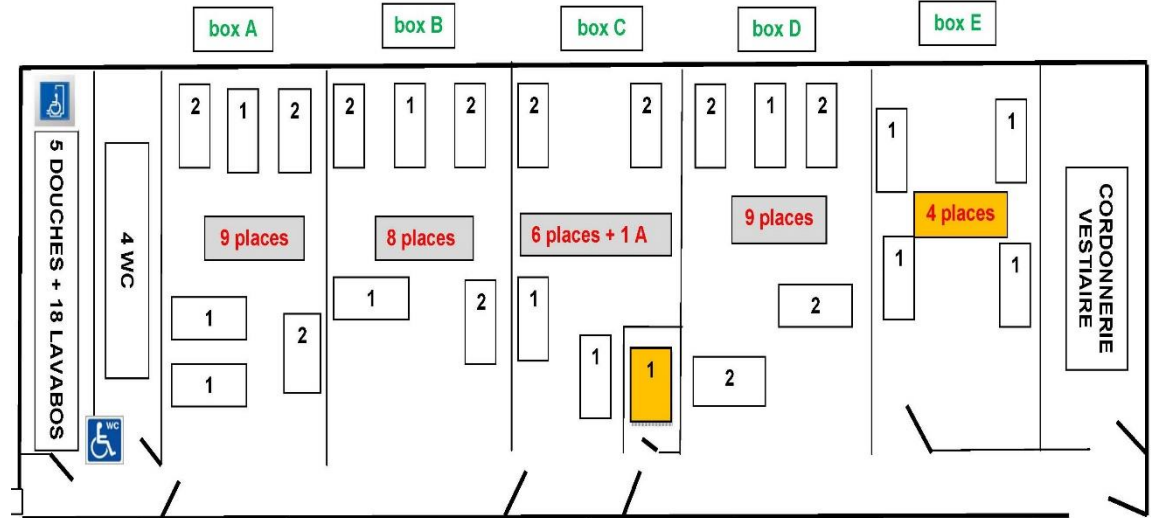

**BÂTIMENT ADMISTRATIF : 1<sup>ER</sup> ETAGE**

**DORTOIR CHAUVE-SOURIS 13 PLACES**

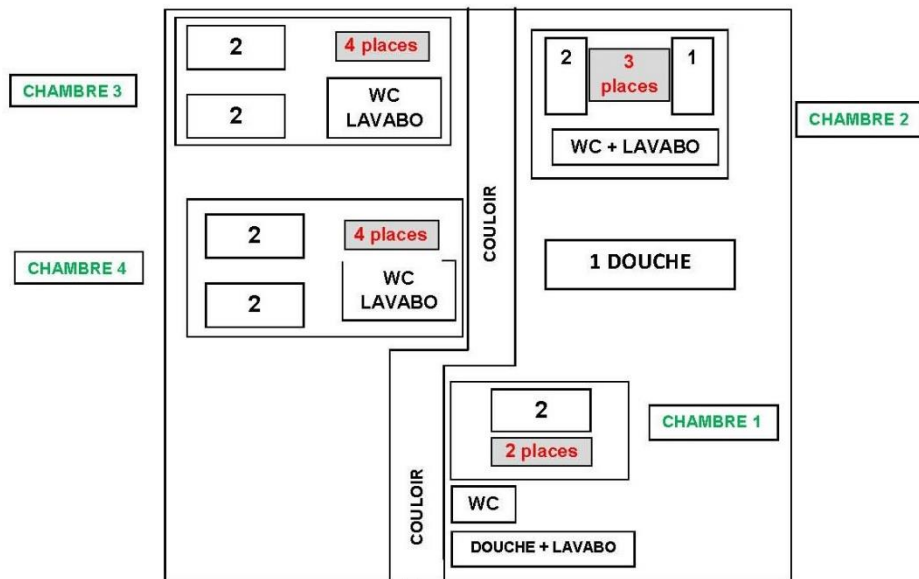

**BÂTIMENT PRINCIPAL : REZ DE CHAUSSEE**

**DORTOIR DESMAN : 37 PLACES**

